

AKCE

III/34711 Lučice – most ev.č. 34711-2

STAVEBNÍK:



Kraj Vysočina

Žižkova 1882/57

587 33 Jihlava

INVESTOR:

**Krajská správa a údržba  
silnic Vysočiny**  
příspěvková organizace



Krajská správa a údržba silnic Vysočiny, příspěvková organizace

Kosovská 1122/16

586 01 Jihlava 1

H

SOUŘADNICOVÝ SYSTÉM

: S-JTSK

VÝŠKOVÝ SYSTÉM

: Bpv

PDPS

VEDOUcí PROJEKTANT	Ing. Martin ŘEHULKA		 PROJEKČNÍ KANCELÁŘ PRIS spol. s r. o. OSO VÁ 20, 625 00 BRNO		
ZODPOVĚDNÝ PROJEKTANT	Ing. Bronislav ŠUSTR				
VYPRACOVAL	Ing. Kateřina MRHAČOVÁ				
KONTROLOVAL	Ing. Jiří ŠRUBAŘ				
KRAJ	VYSOČINA	STAVEBNÍK	Kraj Vysočina	DATUM	10/2022
AKCE  III/34711 Lučice – most ev.č. 34711-2				FORMÁT	
				MĚŘÍTKO	
				STUPEŇ	PDPS
				Čís. ZAKÁZKY	21199
				ARCHIVNÍ Čís.	H2_ZAM.pdf
PŘÍLOHA  ZAMĚŘENÍ				Čís. SOUPRAVY	Čís. VÝKRESU  H.2



# SITUACE 1:100

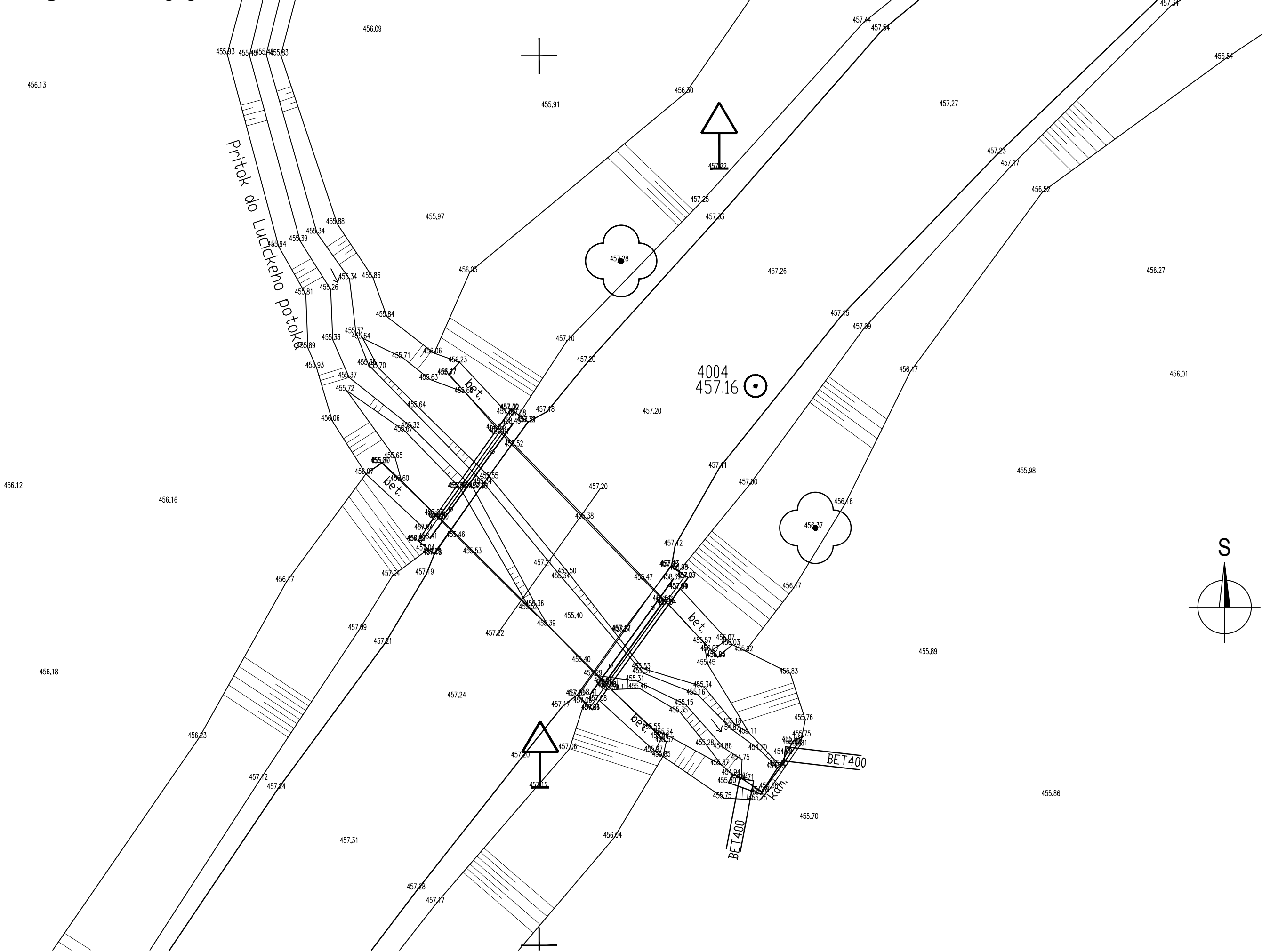



000000000001	671302.91	1098687.90	457.03		000000000022	671302.26	1098687.15	455.58	H
KR					000000000023	671302.23	1098687.14	455.57	H
000000000002	671303.20	1098688.31	457.04		000000000024	671301.86	1098687.14	455.32	P
KR					000000000025	671298.41	1098688.26	455.49	
000000000003	671303.20	1098688.31	456.93		KAM				
KR					000000000026	671299.17	1098689.54	455.50	H
000000000004	671302.91	1098687.90	457.00		000000000027	671299.35	1098689.68	455.34	P
SRIM					000000000028	671300.08	1098690.46	455.36	P
000000000005	671302.83	1098687.96	456.91		000000000029	671300.26	1098690.55	455.52	
SRIM					HBET				
000000000006	671302.76	1098688.02	456.60		000000000030	671301.83	1098688.98	455.53	
SNOS					KAM				
000000000007	671301.05	1098685.63	456.61		000000000031	671302.30	1098688.52	455.46	
SNOS					KAMBET				
000000000008	671301.11	1098685.57	456.91		000000000032	671303.87	1098686.94	455.60	
SRIM					BETP				
000000000009	671301.18	1098685.49	457.03		000000000033	671304.05	1098686.30	455.65	P
SRIM					000000000034	671304.43	1098686.44	456.07	
000000000010	671301.18	1098685.49	457.07		KR				
KR					000000000035	671304.41	1098686.44	455.80	
000000000011	671300.88	1098685.06	457.06		KR				
KR					000000000036	671304.87	1098686.75	456.07	
000000000012	671300.88	1098685.05	456.96		KR				
KR					000000000037	671303.07	1098688.56	458.41	
000000000013	671302.24	1098683.61	456.23		ZABR				
KR					000000000038	671300.73	1098685.33	458.43	
000000000014	671302.54	1098683.94	456.17		ZABR				
KR					000000000039	671303.77	1098685.55	455.67	H
000000000015	671302.55	1098683.96	455.77		000000000040	671303.57	1098685.45	455.32	P
KR					000000000041	671302.95	1098683.36	456.06	
000000000016	671302.07	1098684.47	455.68	P	HP				
000000000017	671303.06	1098684.10	455.63	P	000000000042	671303.83	1098683.49	455.71	P
000000000018	671303.40	1098684.87	455.64	H	000000000043	671304.96	1098682.94	455.64	
000000000019	671300.66	1098685.97	455.52		HP				
BETKAM					000000000044	671305.18	1098682.90	455.41	P
000000000020	671301.36	1098686.87	455.55	H					
000000000021	671301.54	1098687.03	455.34	P					

000000000045	671305.85	1098683.12	455.40	P	000000000072	671308.77	1098674.95	455.93	H
000000000046	671306.26	1098683.76	455.93	H	000000000073	671307.32	1098680.36	455.94	P
000000000047	671305.82	1098685.25	456.06	H	000000000074	671306.72	1098680.20	455.39	P
000000000048	671305.41	1098684.41	455.72		000000000075	671306.24	1098679.99	455.34	P
HP					000000000076	671305.68	1098679.72	455.88	H
000000000049	671305.34	1098684.04	455.37	6	000000000077	671304.67	1098681.24	455.86	H
000000000050	671304.80	1098683.68	455.36	6	000000000078	671305.33	1098681.27	455.34	P
000000000051	671304.52	1098683.77	455.70	H	000000000079	671305.86	1098681.57	455.26	P
000000000052	671314.73	1098687.14	456.12		000000000080	671306.56	1098681.70	455.81	H
TEREN					000000000081	671306.50	1098683.21	455.89	H
000000000053	671314.07	1098675.89	456.13		000000000082	671305.80	1098682.98	455.33	P
TEREN					000000000083	671305.15	1098682.79	455.37	P
000000000054	671314.78	1098662.18	456.17		000000000084	671304.28	1098682.33	455.84	H
TEREN					000000000085	671302.88	1098679.59	455.97	
000000000055	671308.12	1098661.88	456.18	P	TEREN				
000000000056	671307.53	1098661.75	455.71	P	000000000086	671301.95	1098681.08	456.03	P
000000000057	671307.10	1098661.75	455.68	P	000000000087	671328.89	1098720.14	456.84	
000000000058	671306.33	1098661.89	456.13	H	TEREN				
000000000059	671299.92	1098664.10	456.16		000000000088	671327.73	1098721.04	456.87	P
TEREN					000000000089	671326.68	1098722.02	457.15	H
000000000060	671306.77	1098666.85	456.01	H	000000000090	671326.16	1098722.38	457.25	A
000000000061	671307.04	1098666.97	455.61	P	000000000091	671324.77	1098723.71	457.42	A
000000000062	671307.46	1098667.21	455.63	P	000000000092	671323.57	1098724.96	457.48	H
000000000063	671308.01	1098667.63	456.14	H	000000000093	671323.13	1098725.27	457.36	H
000000000064	671307.06	1098668.66	455.98	H	000000000094	671321.08	1098724.68	456.81	
000000000065	671306.57	1098668.43	455.54	P	STL				
000000000066	671306.07	1098668.46	455.52	P	000000000095	671321.93	1098728.01	456.02	P
000000000067	671305.49	1098668.18	456.01	H	000000000096	671316.93	1098730.13	455.67	
000000000068	671304.64	1098674.31	456.09		TEREN				
TEREN					000000000097	671296.43	1098690.35	456.90	
000000000069	671307.26	1098674.98	455.83	H	SRIM				
000000000070	671307.67	1098674.96	455.48	P	000000000098	671296.36	1098690.42	457.04	
000000000071	671308.14	1098674.99	455.45	P	SRIM				

000000000099	671296.36	1098690.42	457.04		000000000121	671289.02	1098691.81	455.89	
KR					TEREN				
000000000100	671296.04	1098689.97	457.04		000000000122	671281.97	1098684.01	456.01	
KR					TEREN				
000000000101	671296.03	1098689.97	457.00		000000000123	671273.58	1098677.75	456.58	
KR					TEREN				
000000000102	671296.50	1098690.31	456.61		000000000124	671285.57	1098695.80	455.86	
SRIM					TEREN				
000000000103	671298.15	1098692.61	456.61		000000000125	671288.88	1098700.53	455.81	
SRIM					TEREN				
000000000104	671298.10	1098692.66	456.92		000000000126	671293.85	1098701.91	455.86	
SRIM					TEREN				
000000000105	671298.04	1098692.73	457.06		000000000127	671297.89	1098696.97	456.04	P
SRIM					000000000128	671295.30	1098694.37	455.28	H
000000000106	671298.05	1098692.74	457.10		000000000129	671294.53	1098693.76	455.18	H
KR					000000000130	671294.58	1098693.94	454.87	P
000000000107	671298.31	1098693.12	457.08		000000000131	671294.80	1098694.46	454.86	P
KR					000000000132	671296.04	1098693.45	455.35	H
000000000108	671296.74	1098694.55	455.97		000000000133	671295.36	1098692.74	455.34	H
KR					000000000134	671295.55	1098692.95	455.16	P
000000000109	671296.57	1098694.17	455.96		000000000135	671295.88	1098693.24	455.15	P
KR					000000000136	671294.09	1098694.04	455.11	
000000000110	671296.43	1098694.28	455.57		HP				
KR					000000000137	671295.26	1098692.11	455.45	P
000000000111	671296.52	1098694.69	455.85		000000000138	671295.37	1098691.49	455.57	P
HP					000000000139	671297.02	1098689.72	455.47	
000000000112	671294.81	1098695.86	455.75	H	KAMBET				
000000000113	671293.81	1098695.92	455.75	H	000000000140	671298.77	1098692.03	455.40	
000000000114	671293.50	1098695.58	455.68	H	KAMBET				
000000000115	671292.67	1098694.38	455.81	H	000000000141	671297.09	1098692.22	455.53	H
000000000116	671292.52	1098693.66	455.76	H	000000000142	671297.07	1098692.35	455.31	P
000000000117	671292.94	1098692.36	455.83	H	000000000143	671297.26	1098692.57	455.31	P
000000000118	671294.20	1098691.73	455.92		000000000144	671297.18	1098692.78	455.46	H
HP					000000000145	671297.97	1098692.81	455.59	H
000000000119	671292.85	1098689.96	456.17	P					
000000000120	671291.40	1098687.59	456.16	P					





000000000190	671298.51	1098693.38	457.06		000000000214	671307.10	1098689.78	456.17	P
SRIM					000000000215	671310.38	1098687.55	456.16	
000000000191	671303.41	1098688.63	456.99		TEREN				
SRIM					000000000216	671313.73	1098692.38	456.18	
000000000192	671303.40	1098688.62	457.27		TEREN				
VRIM					000000000217	671309.56	1098694.17	456.23	P
000000000193	671302.96	1098688.99	457.29		000000000218	671307.84	1098695.34	457.12	H
VRIM					000000000219	671307.34	1098695.60	457.24	H
000000000194	671302.95	1098689.02	457.18	A	000000000220	671305.29	1098697.12	457.31	H
000000000195	671303.17	1098689.57	457.19	A	000000000221	671303.41	1098698.42	457.28	H
000000000196	671303.15	1098688.89	457.04	H	000000000222	671302.87	1098698.80	457.17	P
000000000197	671304.12	1098689.61	457.04	H	000000000223	671300.80	1098700.40	455.92	P
000000000198	671301.66	1098687.16	457.18	A	000000000224	671298.59	1098702.11	455.85	
000000000199	671301.66	1098687.15	457.30		TEREN				
VRIM					000000000225	671303.11	1098709.62	455.73	
000000000200	671300.32	1098685.29	457.32		TEREN				
VRIM					000000000226	671306.29	1098707.35	455.83	P
000000000201	671300.30	1098685.29	457.21	A	000000000227	671308.28	1098705.68	457.33	H
000000000202	671299.78	1098685.00	457.18	A	000000000228	671308.63	1098705.31	457.41	A
000000000203	671300.58	1098685.10	457.08	H	000000000229	671310.41	1098704.23	457.46	A
000000000204	671300.79	1098684.93	457.30		000000000230	671312.29	1098702.97	457.42	A
VRIM					000000000231	671312.60	1098702.71	457.33	H
000000000205	671300.78	1098684.94	457.02		000000000232	671314.50	1098701.34	456.30	
SRIM					TEREN				
000000000206	671297.64	1098691.15	457.17		000000000233	671318.05	1098698.58	456.31	
SRIM					TEREN				
000000000207	671297.65	1098691.16	457.17	A	000000000234	671323.12	1098706.44	456.43	P
000000000208	671297.62	1098691.18	457.31		000000000235	671323.52	1098706.21	456.41	
VRIM					TEREN				
000000000209	671299.97	1098695.56	457.12		000000000236	671319.45	1098708.75	456.49	P
DZ					000000000237	671317.32	1098709.90	457.31	H
000000000210	671300.48	1098694.71	457.20	A	000000000238	671316.88	1098710.13	457.43	A
000000000211	671302.27	1098693.03	457.24	A	000000000239	671315.43	1098711.35	457.48	A
000000000212	671304.34	1098691.52	457.21	A	000000000240	671314.05	1098712.42	457.44	A
000000000213	671305.06	1098691.13	457.09	H					

000000000241	671313.70	1098712.75	457.38	H	000000000268	671286.26	1098686.73	455.98	
000000000242	671311.30	1098714.90	455.82	P	TEREN				
000000000243	671307.85	1098717.41	455.62		000000000269	671282.62	1098681.10	456.27	
TEREN					TEREN				
000000000244	671313.95	1098716.36	456.32		000000000270	671285.85	1098678.82	456.52	P
STL					000000000271	671286.72	1098678.08	457.17	H
000000000245	671313.18	1098723.88	455.76		000000000272	671287.10	1098677.74	457.23	A
TEREN					000000000273	671288.44	1098676.41	457.27	A
000000000246	671316.08	1098721.28	455.94	P	000000000274	671290.36	1098674.28	457.54	A
000000000247	671319.54	1098719.98	457.46	H	000000000275	671290.88	1098674.06	457.44	H
000000000248	671319.28	1098720.18	457.38	H	000000000276	671293.67	1098672.83	456.49	P
000000000249	671320.85	1098718.76	457.44	A	000000000277	671295.88	1098668.65	456.13	
000000000250	671322.20	1098717.54	457.33	H	TEREN				
000000000251	671322.63	1098717.08	457.23	H	000000000278	671295.88	1098676.04	456.30	P
000000000252	671323.70	1098714.82	456.56	P	000000000279	671299.63	1098676.44	455.91	
000000000253	671326.78	1098712.51	456.60		TEREN				
TEREN					000000000280	671278.11	1098677.27	456.43	
000000000254	671294.08	1098687.04	457.00	H	TEREN				
000000000255	671294.93	1098686.57	457.11	A	000000000281	671280.71	1098675.08	456.54	P
000000000256	671296.78	1098685.05	457.20	A	000000000282	671282.24	1098673.59	457.34	H
000000000257	671298.63	1098683.60	457.20	A	000000000283	671282.50	1098673.31	457.38	A
000000000258	671299.22	1098683.01	457.10	H	000000000284	671283.69	1098671.66	457.56	A
000000000259	671297.70	1098680.77	457.28		000000000285	671284.88	1098669.77	457.69	A
STJ					000000000286	671285.12	1098669.43	457.63	A
000000000260	671295.44	1098679.10	457.25	H	000000000287	671287.02	1098666.97	456.96	P
000000000261	671295.02	1098679.55	457.33	H	000000000288	671289.32	1098662.57	456.43	
000000000262	671295.01	1098679.59	457.33	A	TEREN				
000000000263	671294.94	1098678.17	457.22		000000000289	671282.93	1098658.02	456.59	
DZ					TEREN				
000000000264	671293.26	1098681.12	457.26	A	000000000290	671280.52	1098662.31	456.92	P
000000000265	671291.50	1098682.30	457.15	A	000000000291	671278.75	1098665.64	457.80	A
000000000266	671290.88	1098682.67	457.09	H	000000000292	671278.54	1098666.16	457.87	A
000000000267	671289.57	1098683.88	456.17	P	000000000293	671277.61	1098668.16	457.70	A
					000000000294	671276.65	1098669.86	457.51	A

000000000295	671276.45	1098670.31	457.44	H
000000000296	671275.60	1098671.66	456.87	P
000000000297	671273.10	1098674.73	456.73	
TEREN				
000000000298	671266.74	1098673.59	457.53	
CESTA				
000000000299	671264.52	1098672.23	457.55	
CESTA				
000000000300	671264.86	1098669.20	457.69	
CESTA				
000000000301	671268.10	1098669.73	457.62	
CESTA				
000000000302	671269.94	1098667.62	457.80	A
000000000303	671270.56	1098665.39	458.00	A
000000000304	671271.02	1098663.54	458.13	A
000000000305	671270.89	1098662.71	458.11	H
000000000306	671263.11	1098661.33	458.45	H
000000000307	671263.05	1098661.81	458.47	A
000000000308	671262.81	1098664.09	458.38	A
000000000309	671262.76	1098666.70	458.14	A
000000000310	671270.81	1098669.96	457.05	P
000000000311	671263.83	1098658.21	457.47	P
000000000312	671270.48	1098654.49	457.44	
TEREN				
000000000313	671272.24	1098659.26	457.11	P
000000000314	671293.10	1098694.62	454.88	
BET400				
000000004001	671292.37	1098696.44	455.70	
000000004002	671269.99	1098667.33	457.77	
000000004003	671313.01	1098709.71	457.49	
000000004004	671293.92	1098684.28	457.16	